



VONE

HOTEL & APARTMENTS

IDEAL LOCATION

VOne Hotel and Apartments is perfectly placed in the heart of Bahria Town and enjoys the best of twin cities. The project boasts a serene location in Bahria Town Islamabad in just touching distance from some of the most prominent buildings in the city.

- Located in Phase 7 Bahria Town Islamabad.
- Banks, Restaurants, and Shopping Malls located nearby.
- Right next to Bahria Expressway.
- Just one-minute drive from Clock Tower.



DISCOVER VONE HOTEL & APARTMENTS

VOne Hotel & Apartments - a sophisticated heaven in the heart of Bahria Town Islamabad's prestigious Phase 7. VOne Hotel & Apartments is where refinement and relaxation go hand in hand. This unique collection of stylish, characterful apartments mixes the best of contemporary urban living with the natural landscapes of Islamabad's Margalla Hills. From its private landscaped gardens to its distinguished architecture, it is a building that will become a new landmark and symbol of glory.



UNPARALLELED AMENITIES

VOne Hotel & Apartments is introducing new means of luxury and class with global standard facilities that not just add value to your lifestyle but make it an ideal opportunity to invest in a project of this stature. Some of the amenities offered include:

- Gated Community Living
- 24/7 Security Surveillance
- Indoor Swimming Pools
- Gymnasium
- Health Club
- Table Tennis Court
- Kids Play Area
- Daycare Facility
- Community Halls For Events
- Fine Dine Restaurants
- Mini Commercial Zone
- Dedicated Car Parking
- Electric Car Charging Station
- Central Green Courtyard
- Fully Serviced Studio, 1, 2, 3 & 4-Bed Apartments
- Private Balconies
- Large Terraces With Personal Pools
- Roof Top Lounges
- Voice Activated Smart Apartments
- 24/7 Room Service



HOTEL



APARTMENTS



AMENITIES

PROPERTIES AVAILABLE

Choose from a variety of properties offered at VOne Hotel & Apartments including truly luxury apartments, duplexes, and penthouses. Each apartment comes with a plethora of features that segregates this project from others. Let us leave your mind guessing in anticipation as to what awaits you in this luxurious project to ever embrace the lands of Islamabad.

- Studio Apartments
- 1, 2, 3, and 4-Bedroom Apartments
- Penthouses
- Private Pool Apartments



STUDIO APARTMENT (1ST TO 17TH FLOOR)



Gross Area 849.55 sqft

S.No.	Apt.No	Type	Gross Area	Rate Per Sq Ft	Total Price	30% Down Payment	60 Monthly Installments	10% Possession
1	105	B	790.20	10,000	7,901,991	2,370,598	79,020	790,199
2	106	C	896.54	10,000	8,965,415	2,689,624	89,654	896,541
3	117	A	849.55	10,000	8,495,456	2,548,636	84,955	849,546

1 BED APARTMENT (1ST TO 17TH FLOOR)

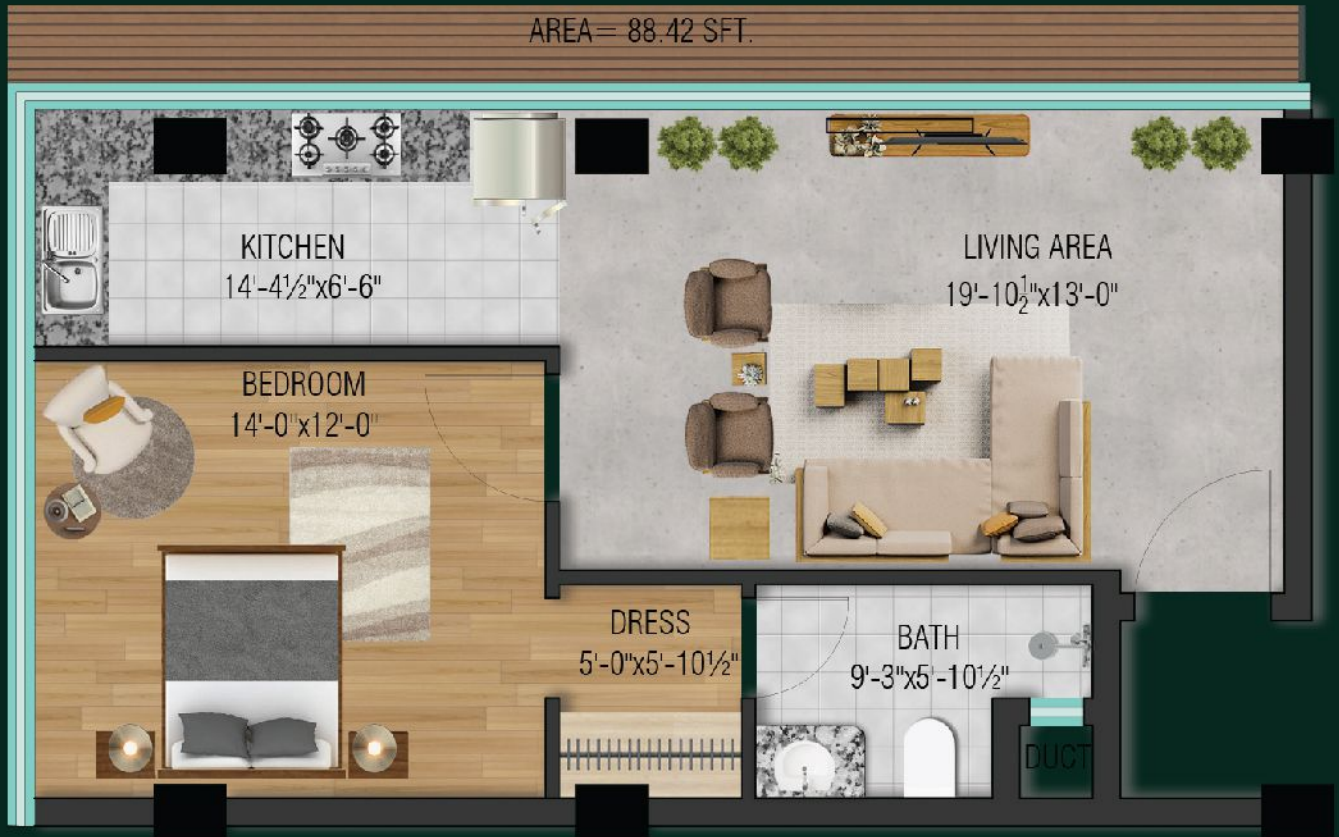

Gross Area 949.92 sqft

S.No.	Apt.No	Type	Gross Area	Rate Per Sq Ft	Total Price	30% Down Payment	60 Monthly Installments	10% Possession
4	102	A	949.92	10,000	9,499,227	2,849,768	94,992	949,923
5	101	B	1095.85	10,000	10,958,499	3,287,550	109,585	1,095,850
6	104	C	1120.71	10,000	11,207,063	3,362,120	112,071	1,120,706
7	118	D	1040.30	10,000	10,402,969	3,120,890	104,030	1,040,297
8	119	D (ALTRED)	1015.30	10,000	10,152,970	3,045,892	101,530	1,015,297
9	1515	E	886.59	10,000	8,865,897	2,659,770	88,659	886,590
10	1615	E	913.22	10,000	9,132,207	2,739,662	91,322	913,221
11	1715	E	918.14	10,000	9,181,377	2,754,414	91,814	918,138
12	1616	F	907.62	10,000	9,076,175	2,722,852	90,762	907,617
13	1716	F	955.79	10,000	9,557,865	2,867,360	95,579	955,786

2 BED APARTMENT (1ST TO 17TH FLOOR)



Gross Area 1706.45 sqft

S.No.	Apt.No	Type	Gross Area	Rate Per Sq Ft	Total Price	30% Down Payment	60 Monthly Installments	10% Possession
14	107	A	1706.45	10,000	17,064,505	5,119,352	170,645	1,706,450
15	116	A	1707.56	10,000	17,075,578	5,122,674	170,756	1,707,558
16	113	B	1553.05	10,000	15,530,536	4,659,160	155,305	1,553,054
17	112	C	1682.60	10,000	16,826,040	5,047,812	168,260	1,682,604
18	111	D	1696.44	10,000	16,964,418	5,089,326	169,644	1,696,442
19	110	E	1459.22	10,000	14,592,215	4,377,664	145,922	1,459,222

3 BED APARTMENT (1ST TO 17TH FLOOR)



Gross Area 2032.35 sqft

S.No.	Apt.No	Type	Gross Area	Rate Per Sq Ft	Total Price	30% Down Payment	60 Monthly Installments	10% Possession
20	121	A	2032.35	10,000	20,323,498	6,097,050	203,235	2,032,350
21	122	A	2074.89	10,000	20,748,943	6,224,682	207,489	2,074,894
22	221	A	2032.35	10,000	20,323,498	6,097,050	203,235	2,032,350
23	621	A	1926.67	10,000	19,266,728	5,780,018	192,667	1,926,673
24	721	A	1823.42	10,000	18,234,158	5,470,248	182,342	1,823,416
25	821	A	1746.48	10,000	17,464,818	5,239,446	174,648	1,746,482
26	822	A	2047.09	10,000	20,470,863	6,141,258	204,709	2,047,086
27	922	A	1942.71	10,000	19,427,073	5,828,122	194,271	1,942,707
28	123	B	2671.80	10,000	26,717,962	8,015,388	267,180	2,671,796
29	124	C	2245.38	10,000	22,453,806	6,736,142	224,538	2,245,381
30	924	C	2951.71	12,000	35,420,520	10,626,156	354,205	3,542,052
31	126	D	2185.99	10,000	21,859,924	6,557,978	218,599	2,185,992
32	125	D	2187.91	10,000	21,879,064	6,563,720	218,791	2,187,906
33	325	D	2,188	10,000	21,879,064	6,563,720	218,791	2,187,906
34	725	D	2893.50	12,000	34,722,000	10,416,600	347,220	3,472,200
35	327	E	3,068	10,000	30,681,605	9,204,482	306,816	3,068,161
36	526	E	2892.68	12,000	34,712,208	10,413,662	347,122	3,471,221
37	320	G	1,811	10,000	18,107,063	5,432,118	181,071	1,810,706

4 BED APARTMENT (1ST TO 17TH FLOOR)



Gross Area 272.69 sqft

S.No.	Apt.No	Type	Gross Area	Rate Per Sq Ft	Total Price	30% Down Payment	60 Monthly Installments	10% Possession
38	127	G	4007.52	10,000	40,075,217	12,022,566	400,752	4,007,522
39	227	A	3839.52	12,000	46,074,185	13,822,256	460,742	4,607,419
40	426	A	4030.17	12,000	48,362,020	14,508,606	483,620	4,836,202
41	625	A	3961.55	12,000	47,538,639	14,261,592	475,386	4,753,864
42	824	B	4022.44	12,000	48,269,227	14,480,768	482,692	4,826,923

PENTHOUSE (1ST TO 17TH FLOOR)

S.No.	Apt.No	Type	Gross Area	Rate Per Sq Ft	Total Price	30% Down Payment	60 Monthly Installments	10% Possession
43	923	A	15248.97	12,000	182,987,643	54,896,292	1,829,876	18,298,764
44	1021	B	4316.90	12,000	51,802,766	15,540,830	518,028	5,180,277
45	1121	C	4140.76	12,000	49,689,149	14,906,744	496,891	4,968,915
46	1220	D	5285.04	12,000	63,420,427	19,026,128	634,204	6,342,043
47	1320	E	4327.98	12,000	51,935,815	15,580,744	519,358	5,193,581
48	1420	F	4310.51	12,000	51,726,119	15,517,836	517,261	5,172,612
49	1516	G	7685.95	12,000	92,231,361	27,669,408	922,314	9,223,136
50	1617	H	5621.97	12,000	67,463,608	20,239,082	674,636	6,746,361
51	1717	I	7072.62	12,000	84,871,432	25,461,430	848,714	8,487,143

FULL PAYMENT PLAN

Accommodation	Types	Apartment Size	Total Price	30% Down Payment	60 Monthly Installments	10 % On Possession
STUDIO	A	850	8,495,500	2,548,650	84,955	849,550
STUDIO	B	790	7,902,000	2,370,600	79,020	790,200
STUDIO	C	897	8,965,400	2,689,620	89,654	896,540
1 BED	A	950	9,499,200	2,849,760	94,992	949,920
1 BED	B	1,096	10,958,500	3,287,550	109,585	1,095,850
1 BED	C	1,121	11,207,100	3,362,130	112,071	1,120,710
1 BED	D	1,040	10,403,000	3,120,900	104,030	1,040,300
1 BED	D (ALTRED)	1,015	10,153,000	3,045,900	101,530	1,015,300
2 BED	A	1,706	17,064,500	5,119,350	170,645	1,706,450
2 BED	B	1,553	15,530,500	4,659,150	155,305	1,553,050
2 BED	C	1,683	16,826,000	5,047,800	168,260	1,682,600
2 BED	D	1,696	16,964,400	5,089,320	169,644	1,696,440
2 BED	E	1,459	14,592,200	4,377,660	145,922	1,459,220
3 BED	A	2,075	20,748,900	6,224,670	207,489	2,074,890
3 BED WITH SERVANT	B	2,672	26,718,000	8,015,400	267,180	2,671,800
3 BED WITH SERVANT	C	2,245	22,453,800	6,736,140	224,538	2,245,380
3 BED WITH SERVANT	D	2,188	21,879,100	6,563,730	218,791	2,187,910
3 BED (Duplex)	F	1,880	18,796,000	5,638,800	187,960	1,879,600
4 BED	A - Pool	3,840	46,074,240	13,822,272	460,742	4,607,424
4 BED	A - Pool	4,030	48,362,040	14,508,612	483,620	4,836,204
4 BED	A - Pool	3,962	47,538,600	14,261,580	475,386	4,753,860
4 BED	B - Pool	4,022	48,269,280	14,480,784	482,693	4,826,928
4 BED	G	4,008	40,075,200	12,022,560	400,752	4,007,520
PENTHOUSE (Triplex)	A - Pool	15,249	182,987,640	54,896,292	1,829,876	18,298,764
PENT HOUSE	B - Pool	4,317	43,169,000	12,950,700	431,690	4,316,900
PENT HOUSE	C - Pool	4,141	49,689,120	14,906,736	496,891	4,968,912
PENT HOUSE	D - Pool	5,285	63,420,480	19,026,144	634,205	6,342,048
PENT HOUSE	E - Pool	4,328	51,935,760	15,580,728	519,358	5,193,576
PENT HOUSE	F - Pool	4,311	51,726,120	15,517,836	517,261	5,172,612
PENT HOUSE	G - Pool	7,686	92,231,400	27,669,420	922,314	9,223,140
PENT HOUSE	H - Pool	5,622	67,463,640	20,239,092	674,636	6,746,364
PENT HOUSE (Duplex)	I - Pool	7,073	84,871,440	25,461,432	848,714	8,487,144



EXCLUSIVELY MARKETING BY

ilaan.com

+92 304 1111 451

A PROJECT BY



INTERNATIONAL

Head Office:

26-A, J3 Block, Johar Town, Lahore.

Islamabad Office:

49, Spring North Commercial, Bahria Town, Phase 7, Islamabad.