

**AHBAB  
VILLAS**  
BLOCK C-1, B-17, ISLAMABAD



**LIVING BEYOND YOUR DREAMS**

# Company Profile

Ahbab Villas is a project under banner of R.F Construction which is a sibling company of Ahbab Housing Society {Pvt.} Limited. Ahbab Housing Society was established in 1990, thus it has a vast history of 29 years of expertise & experience serving in the Housing Industry for our beloved homeland, Pakistan. Ahbab Housing Society has launched, completed & handed over the following projects just to name a few of its endeavors:

## 1. Gulshan-e-Ahbab Phase I

This Project is located at 17 Km Multan Road Lahore, this housing project is situated at an extremely prime location of real-estate. All facilities (roads, water, Electricity) sewerage network & Sui-gas etc) are present & have been provided by Ahbab Housing Society.

## 2. Gulshan-e-Ahbab Phase II

This Project is located at Chandrai Road Link Ferozepur Road, Lahore. It lies in the middle of numerous sizeable Housing & Residential Societies. All facilities ( i.e Roads, Water, Electricity & Sewerage Network) have been catered to by Ahbab Housing Society.

## 3. Gulshan-e-Ahbab Phase III (Shadab Colony)

This project is situated on a major artery of Lahore, Ferozepur Road. It is geographically present at the heart of many posh Housing Societies, making it an expensive & prime piece of Real Estate in the city. All facilities (Roads, Water, Electricity, Sui Gas & Sewerage network) have been provided by Ahbab Housing Society.

## 4. Ahbab Garden Murree

This Project is Located in the hills, surrounded by nature, fresh air & breath-taking views, it is a beautiful & serene project hidden away in the hills of Murree, promising a luxurious & peaceful lifestyle away from the hustle and bustle of the city while still providing all facilities. This project is located at a stones throw from PC Bhurban, making it the perfect location.



## 5. Manzar-e-Kohsar

### Block C-1, Multi Professionals Co-operative Housing Society

This Project was merged with MPCHS and now all members are part of MPCHS, and enjoying the same facilities like:-

- Wide Roads
- Underground Electricity
- Sewer and Water Supply Network
- Water Filtration Plants
- Community Center and Club
- School and University







# Islamabad

Islamabad is one of the most beautiful cities of the world. Lavish wide roads, green Margalla Hills, beautiful Faisal Masjid, Lake View park, Monument and many sky high shopping malls make Islamabad more attractive for the visitors from inland and all over the world.

It is a region-wide symbol of progress, innovation and architectural marvel. There has been a steady growth in the population of the city, which has swelled to somewhere in excess of a million inhabitants. This city is the fastest growing urban settlement in the country. There is an increased interest in the city from both public and private sectors alike, as well as a renewed interest from multinational foreign investors. This has resulted in exponential growth in the economy, produced employment at all levels and has ensured development, owing to all these factors.









# B-17

## Multi Gardens Features

B-17 (MPCHS) is a masterly planned area surrounded by natural beauty, breathtaking view of the Margalla Hills. It would give a feeling of dreams coming true for those who prefer a serene community. Exquisite surroundings, the scheme would prove a project of its own class.

- ▶ Transport Facilities Comprising Coaches and Coasters
- ▶ Few minutes drive from New Islamabad International Airport
- ▶ Adjacent to motorway
- ▶ Beautiful retreat from your busy life
- ▶ Mosques, Schools, Hospital & Swimming Pool
- ▶ Club and Community Centre
- ▶ Wide Roads Network
- ▶ Parks, Zoo, Play Grounds and Landscaping
- ▶ Banks, Hotels and Rest Houses
- ▶ 24 Hours Security and CCTV
- ▶ Modern Waste Collection and Disposal
- ▶ Sewerage Disposal Stations
- ▶ Underground Electricity
- ▶ Sui Gas, Water Supply & Telephone Exchange

### Islamabad Master Plan





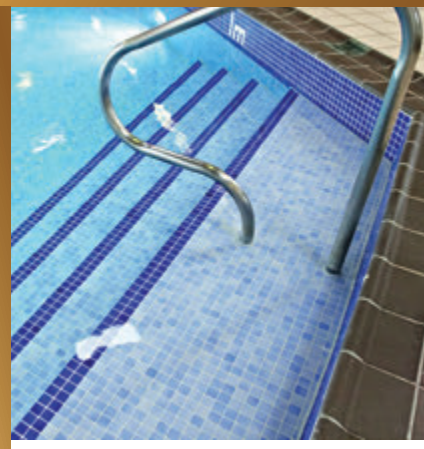





## OPTION-A

- ▶ 2+2 Bedroom  
(Attached Bathroom)
- ▶ 1+1 Drawing Room
- ▶ 1+1 Kitchen
- ▶ 1+1 TV Lounge
- ▶ Car Porch
- ▶ Front & Back Lawn











# Project Features

Ahbab Villas is a turn – key housing project, an endeavor by RF Construction. The project embodies contemporary living combined with luxurious lifestyle & state of the art facilities. Our Villas are functional yet spacious, they provide a perfectly balanced living space with vast spaces of living rooms, the comfort of bedrooms, sterility of bathrooms, practicality of kitchens & capacious car parking.

- ▶ Bedrooms with attached bathrooms.
- ▶ False Ceiling
- ▶ Tiled Flooring
- ▶ Master / Faisal Sanitary fitting.
- ▶ Wooden Doors
- ▶ Aluminum Windows
- ▶ Car Porch
- ▶ Spacious & Stylish Wardrobes
- ▶ Modern Kitchens
- ▶ Drawing & Dining Area
- ▶ Graphic Design and Tiles work on Front Elevation









# 3D View & Layout Plan

## Ground Floor

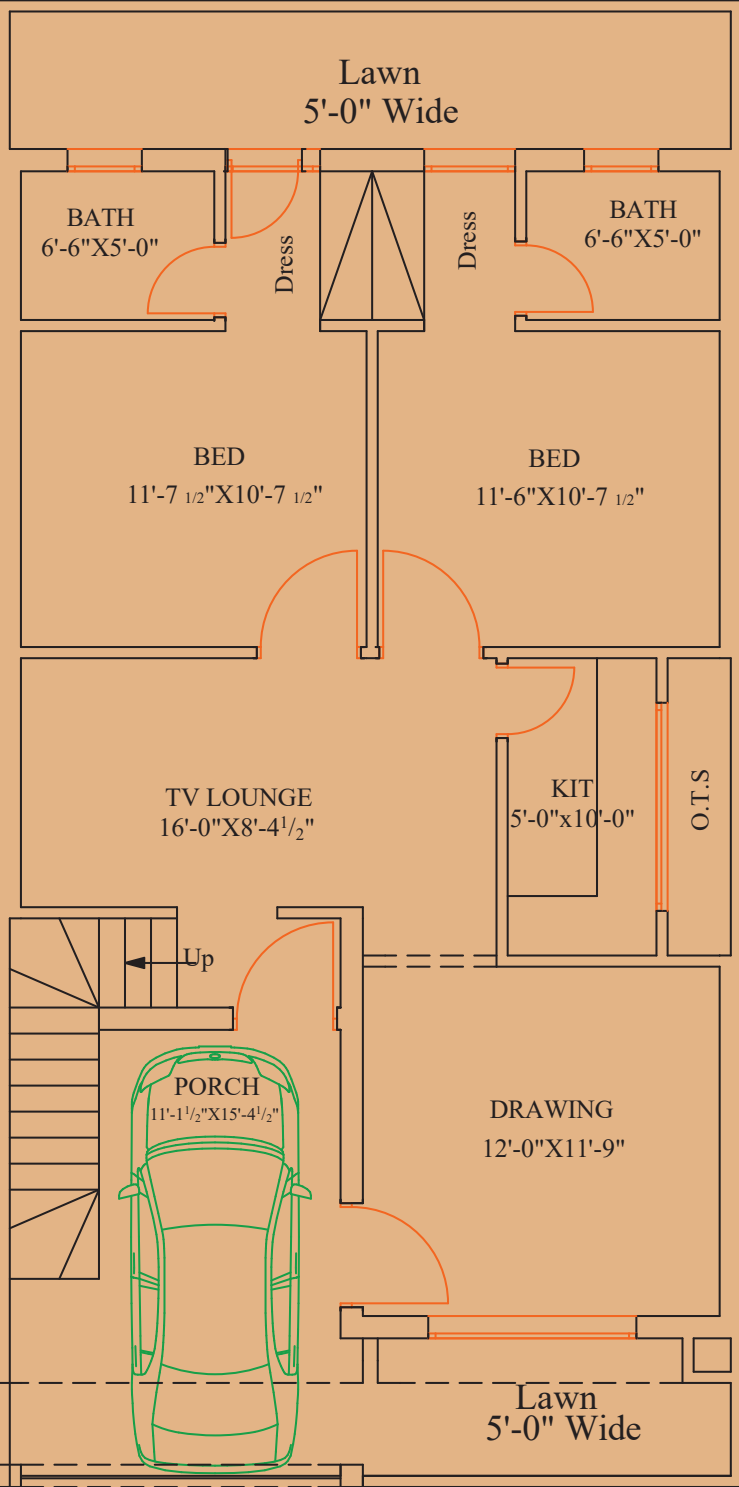



3D View & Layout Plan  
Upper Floor

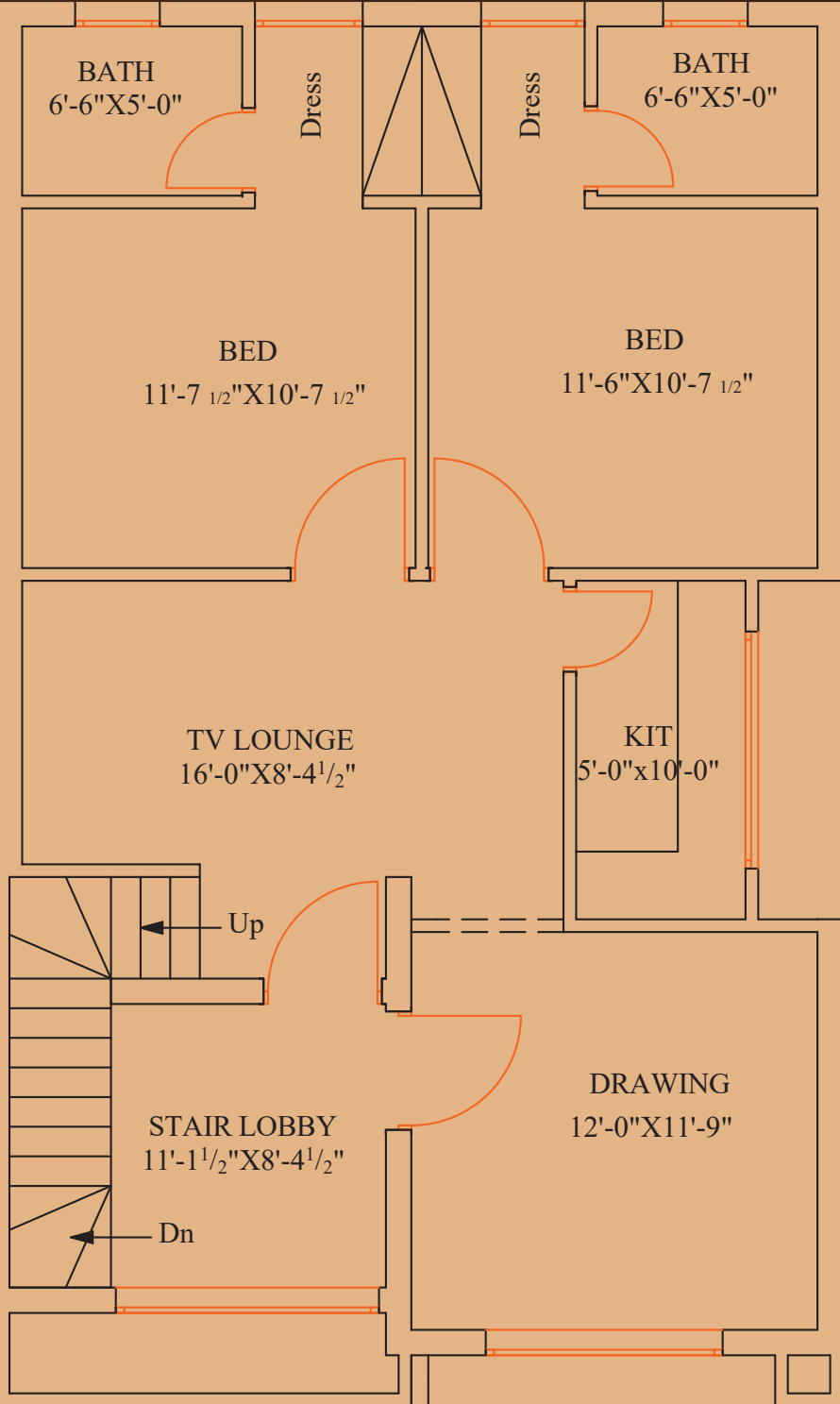





## OPTION-B

- ▶ 1+2 Bedroom  
(Attached Bathroom)
- ▶ Drawing Room
- ▶ 1+1 Kitchen
- ▶ 1+1 TV Lounge
- ▶ Car Porch
- ▶ Front & Back Lawn











 **AHBAB  
VILLAS**  
BLOCK C-1, B-17, ISLAMABAD



# Layout Plan Ground Floor

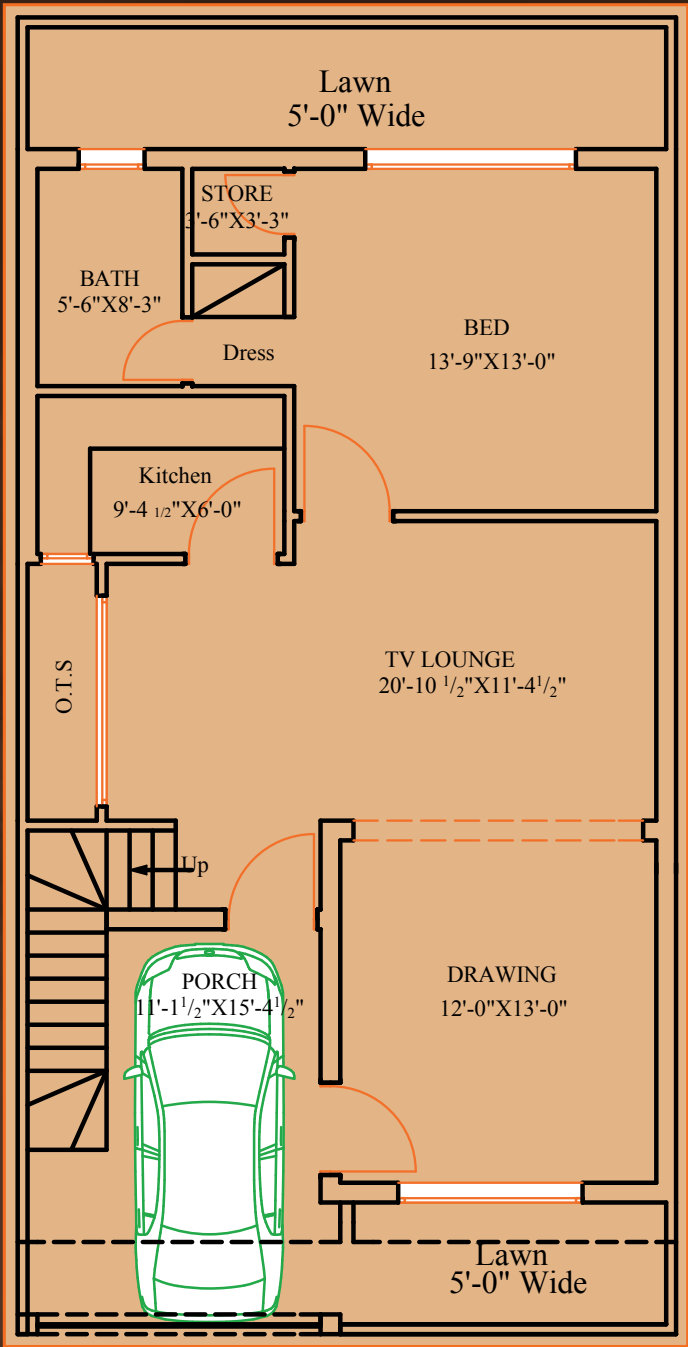

# Layout Plan Upper Floor

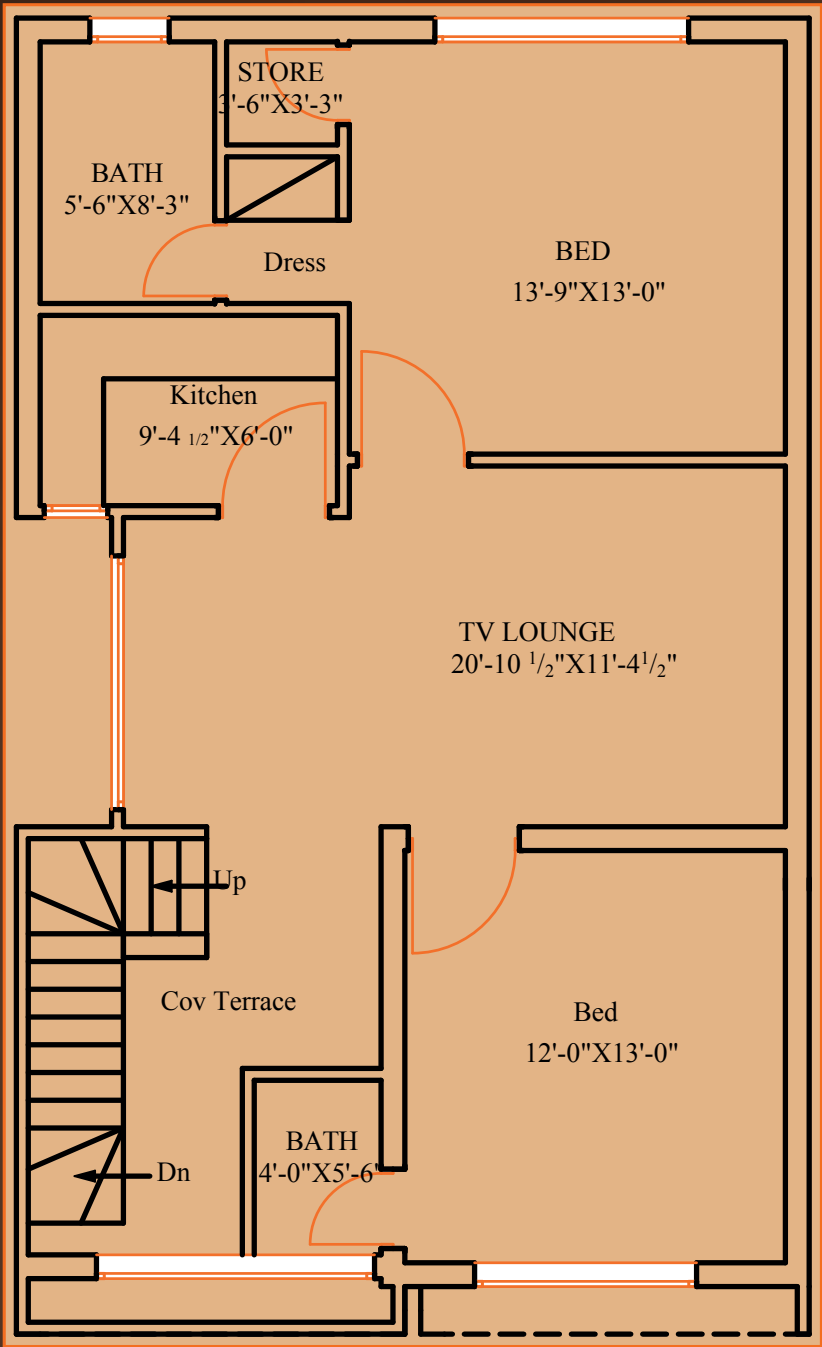













A Project of



**RF CONSTRUCTION**

#### **RF CONSTRUCTION**

374 Mehran Block

Allama Iqbal Town, Lahore.

Tel: +92 42 35412375-76

Mobile: 0300-8422787

Email: ahabavillas@gmail.com

rfconstructionofficial@gmail.com

#### **DISCLAIMER:**

This brochure is conceptual and not a legal offering. Facilities / Layout / Specifications / Plans / Information / Images / Brand names contained herein are indicative and the promoter reserves the right to change, alter, add, or delete any of them mentioned herein without prior permission or notice. The furniture shown in the plans is only for the purpose of illustrating a possible layout and does not form a part of the offering.

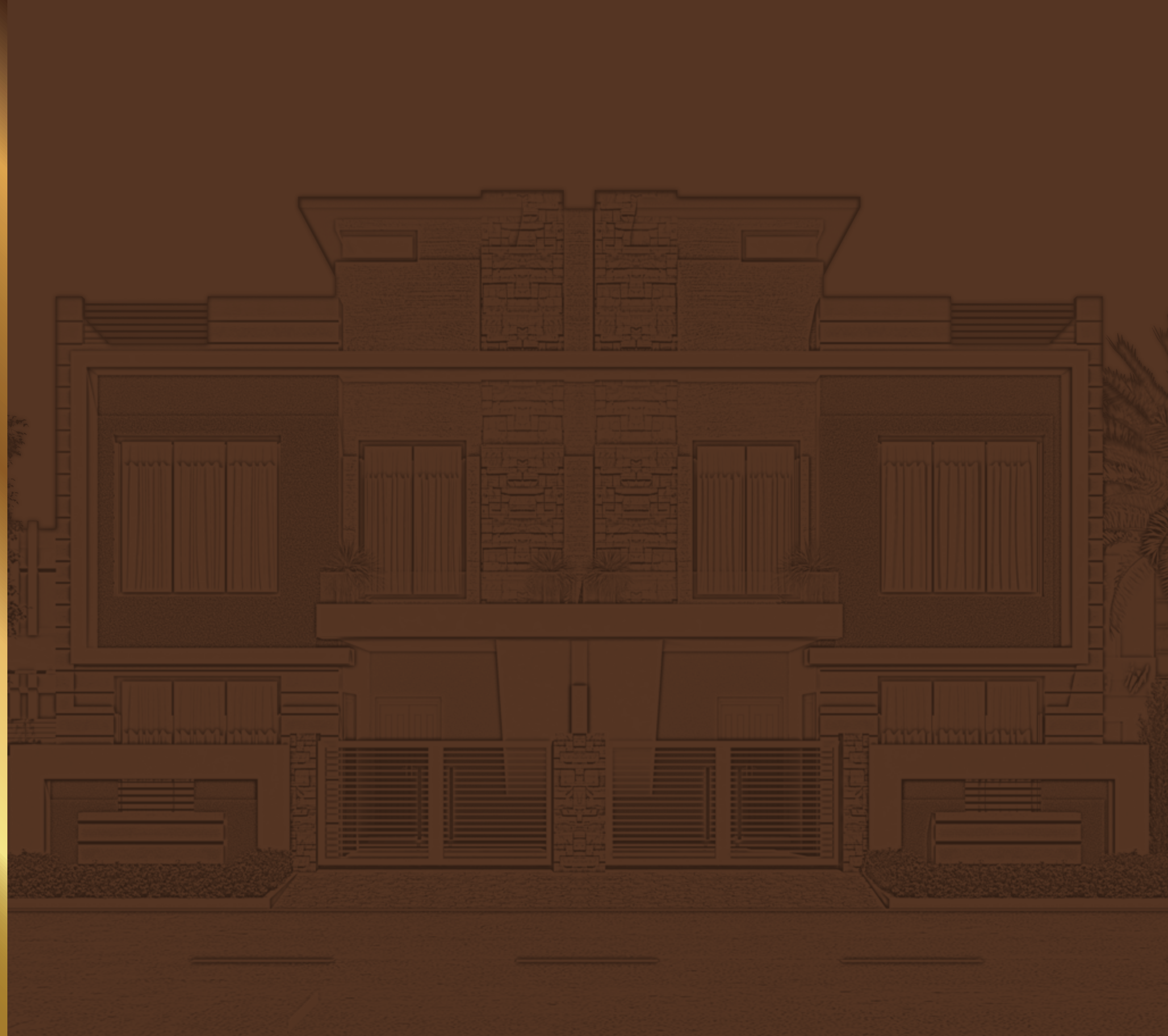

Brochure Design & Printed by



0312-5612389  
0333-3238756